

Mer-Krete Mer-Stik™

DRY POLYMER MASTIC ADHESIVE

1. PRODUCT NAME

Mer-Stik™

Dry polymer mastic adhesive

2. MANUFACTURER

ParexLahabra, Inc.

501 Van Ness Avenue

Torrance, CA 90501

PH (323) 775-2461

FAX (310) 320-4938

(800) 851-6303

www.merkrete.com

3. PRODUCT DESCRIPTION

BASIC USE

Mer-Krete Mer-Stik is a superior grade dry polymer based mastic adhesive for installing ceramic tile and natural stone. **Mer-Stik** is quick setting mastic adhesive, non slump with excellent bond and workability which allows the tile contractor to grout most tile in less than 4 hours. It is recommended for use with absorptive, semi-vitreous and vitreous tile over properly prepared masonry, concrete, and cement backer board. **Mer-Stik** is suitable for wet areas like shower walls.

USES

Mer-Stik can be used as a mastic for ceramic tile and natural stone for both walls and light duty floors in interior applications. It is recommended for use in the mastic adhesive method for absorptive, semi-vitreous, vitreous tile and impervious ceramic tile such as porcelain tile and natural stone over properly prepared masonry, concrete, cement backer board, and existing ceramic tile. In interior dry areas, it is suitable for gypsum board. **Mer-Stik** is suitable for both residential and commercial construction.

ADVANTAGES

Interior use

Bright white

Quick setting

Grout in 4 hours

Freeze thaw stable

Bonds to most surfaces

Suitable for wet areas

Superior adhesion for porcelain tile and stone

Low VOC's meets LEED (IAQ CR 4.1) requirements

Retains consistency after mixing if kept in closed bucket

Built in anti microbial protection for mold and mildew resistance

Suitable as an adhesive over Mer-Krete's waterproof membranes

Powder can be transported in the winter without concern for freezing

SUITABLE SUBSTRATES

Concrete

Concrete Masonry

Cement Mortar Beds

Cement Plaster

Ceramic Tile and Stone

Brick Masonry

Gypsum Wallboard*

Cement Backer Board**

*Interior Use Only

** Consult cement backer board manufacturer for installation recommendations and to verify acceptability for exterior use.

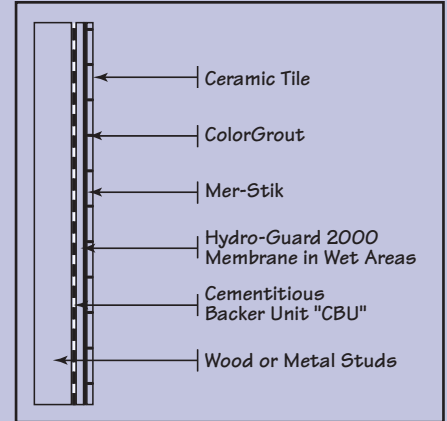

MER-KRETE SYSTEMS
(800) 851-6303

Mer-Krete Systems

501 Van Ness Avenue

Torrance, California 90501

Tel: (323) 775-2461

Fax: (310) 320-4938

Internet: www.merkrete.com

E-mail: info@merkrete.com

For the latest and most current product information, make sure to visit our website at: www.merkrete.com

REV 12/07

Mer-Krete Mer-Stik™

DRY POLYMER MASTIC ADHESIVE

LIMITATIONS

Do not use **Mer-Stik** below 40°F (4°C) or above 95°F (35°C). Use caution; do not allow mastic to freeze for the first 72 hours. Do not soak tiles previous to installation. **Mer-Stik** must not be used to apply over asphalt sheeting, vinyl covered wall board, Masonite®, cement asbestos board, metal, glass, plastic, gypsum mortar beds or other unstable substrates. Improperly cured or wet plywood, particle board or strip wood are not suitable substrates. **Mer-Stik** is not recommended for installations that will be continually wet like swimming pools, fountains and gang showers, and steam showers, use a Mer-Krete Thin Set mortar. Some dimensional stone tile like green and red marbles may warp when installed with water based mastic. These water sensitive stone tiles should be installed with **Mer-Krete ProEpoxy**. For use of **Mer-Stik** over additional substrates or situations not mentioned in these instructions, contact Mer-Krete Technical department.

4. TECHNICAL DATA

APPLICABLE STANDARDS

Mer-Krete's **Mer-Stik** is a unique innovation and currently there are no industry standards for this new technology. Exceeds ANSI 136.1. Follow ANSI A108.4 for installation.

COLOR

White

PACKAGING

25 lbs. bag. When mixed with water will yield approximately 3 1/2 gallons of Mer-Stik.

SHELF LIFE

12 months when stored off the ground in dry heated area. Protect from moisture. High humidity will reduce the shelf life of bagged material.

5. INSTALLATION

SURFACE PREPARATION

All surfaces must be between 40°F (4°C) to 95°F (35°C) and structurally sound (deflection not to exceed 1/360 of the span), dry clean and free from oil, grease, wax, paint, old adhesives, sealers and curing compounds. Any contaminates which inhibit proper bond must be removed. Substrate preparation should be completed following ANSI A108 AN-2 "General Requirements for Sub-surfaces". All substrates should be plumb and true, surface deviation should not exceed 1/4" in 10'. Patching, leveling or areas requiring repair should be prepared using Mer-Krete's Underlayments. Movement (Expansion) joints should be provided to comply with TCA method EJ 171.

Cementitious Substrates

All concrete substrates should be cured a minimum of 28 days. Smooth steel troweled floors should be roughed up using mechanical chipping, scraping or shot blasting. Dampen porous or dry concrete previous to installation of tile. Do not leave puddles or standing water.

Cement Backer Board

Follow cement board manufacturer's instructions.

MIXING

In a clean container, add approximately 4 1/2 quarts (4.7 liters) of clean potable water. Then add the contents of the 25 lb. (11.33kg) **Mer-Stik** adhesive. Mix thoroughly by hand or with a slow speed mixer to a smooth, thick, trowelable consistency. Use immediately. Do not allow to slake. Mastic consistency shall be such that when applied with the recommended notched trowel to the substrate, the ridges formed in the mastic do not flow or slump. During use, stir mastic mix occasionally. Do not temper with additional water. Do not add latex liquid to **Mer-Stik**.

APPLICATION

Apply **Mer-Stik** to the substrate with the flat side of the trowel, with enough pressure to firmly work into the surface. With a notched trowel, immediately follow with a heavier coat of material using the appropriate trowel and enough mortar to provide 100% coverage to the back of the tile.

Mer-Krete Systems
501 Van Ness Avenue
Torrance, California 90501

Tel: (323) 775-2461
Fax: (310) 320-4938
Internet: www.merkrete.com
E-mail: info@merkrete.com



MER-KRETE SYSTEMS
(800) 851-6303

Mer-Krete Mer-Stik™

DRY POLYMER MASTIC ADHESIVE

Some extruded or lug back tiles back-buttering of tiles may be required. Do not spread more mastic than can be covered in 30 minutes or before the mastic skins over. A minimum final bed thickness of 1/16" is recommended for wall tile. It is advised that during the installation, remove a tile to insure the mastic has not skinned over and check the tile and substrate mastic adhesive coverage. Comb the mastic using an appropriate notched trowel in one direction. Place tiles in mortar, slide back and forth perpendicular to the ridges (NTCA "Trowel and Error" method) to insure proper coverage. Do not adjust tiles set in mastic after 15 minutes.

CLEANING

Water is all that is needed to remove any uncured mastic from tiles, tools and equipment.

6. AVAILABILITY

Mer-Krete **Mer-Stik** is available at leading tile houses and construction distributors. Contact Mer-Krete for the name of the nearest dealer.

7. WARRANTY

5 year, 10 year and Limited Lifetime warranties are available. Contact Mer-Krete technical department for specific warranty information. Mer-Krete Systems warrants that this product meets applicable ANSI standards in force at the time of manufacture. Mer-Krete will replace any product which proves defective due to quality of ingredients used or due to the manufacturing process itself. The warranty shall apply only if the product is installed and used strictly in accordance with applicable industry standards, specifications, and instructions provided by Mer-Krete. Mer-Krete shall not be liable for misapplication, misuse or abuse of the product, application or other event outside of its control. Replacement of defective product or, at Mer-Krete's option, refund of the price of product of any defective item shall be the buyer's sole remedy under this warranty. Mer-Krete shall in no event be liable for any damages in excess of the purchase price of the defective product. MER-KRETE SHALL IN NO EVENT BE LIABLE FOR ANY CONSEQUENTIAL, INCIDENTAL OR SPECIAL DAMAGES.

This warranty constitutes the sole and exclusive warranty given by Mer-Krete Systems in connection with this product, and Mer-Krete Systems has authorized no person to make or give any other warranties, or representations, oral or written, on its behalf. IN PARTICULAR, THERE ARE NO IMPLIED WARRANTIES, INCLUDING WITHOUT EXCEPTION, WARRANTIES, MERCHANTABILITY OR FITNESS FOR A PARTICULAR PURPOSE. No modification of this warranty in favor of any buyer shall be valid unless given in writing and signed by an officer of Mer-Krete Systems.

8. MAINTENANCE

None required, but installation performance and durability may depend on properly maintaining products supplied by other manufacturers.

9. TECHNICAL SERVICES

Mer-Krete Systems maintains technical field representatives available throughout the country. Call (800) 851-6303 for the nearest representative.

10. FILING SYSTEMS

Mer-Krete Architectural Product Catalog and CD Rom.
www.merkrete.com

Mer-Krete Systems
501 Van Ness Avenue
Torrance, California 90501

Tel: (323) 775-2461
Fax: (310) 320-4938
Internet: www.merkrete.com
E-mail: info@merkrete.com



MER-KRETE SYSTEMS
(800) 851-6303